



YB3 系列隔爆型三相异步电动机
YB3 Frame-proof Three-phase Asynchronous Motors

YB3 系列隔爆型三相异步电动机

YB3 Series Frame-proof Three-phase Asynchronous Motors

YB3 系列隔爆型三相异步电动机是 YB2 系列的换代产品。本系列电动机具有体积小、重量轻、外形美观、运行可靠、性能好、使用维护方便的优点。电动机的功率等级、安装尺寸符合 IEC 标准。

电动机防爆性能符合 GB3836.1-2000《爆炸性气体环境用电气设备第 1 部分：通用要求》和 GB3836.2-2000《爆炸性气体环境用电气设备第 2 部分：隔爆型“d”》的规定，分别制成隔爆型 ExdI、ExdIIAT4、ExdII BT4、ExdII CT4，适用于煤矿井下（非采掘工作面）及工厂 IIA、IIB、IIC 级，温度组分别为 T1-T4 的爆炸性气体环境的场所。也可以制成 YB3-W 户外型、YB3-TH 户内湿热型、YB3-WTH 户外湿热型、YB3-WT 户外热带型及 YB3-WF1 户外中等防腐蚀气体环境。

YB3 series flame-proof three-phase asynchronous motors are the updated specifications of YB2 series with the features of small size, lightness, good appearance, reliable operation, good stability, low noise, tiny vibrations as well as convenient use and maintenance. The power ranking and installation size of this series meet with IEC standard.

The explosion-proof performance reaches the standards in GB 3836.1-2000 Electric Equipment for Using in the Explosive Gas Environment part 1: Currency Need and GB3836.2-2000 Electric Equipment for Using in the Explosive Gas Environment part 2: Flame-pooof “d” to respectively form the flame-proof types of ExdI, ExdIIAT4, ExdII BT4 and ExdII CT4, which are suitable for the non-mining working area in underground mine and the IIA, IIB and IIC level of dangerous places in the factories with T1-T4 temperature degrees of explosive gas-mixture environment.

This series can also be machined into YB3-W for outdoor use, YB3-TH for wet and hot indoor environment, YB3-WTH for wet and hot outdoor environment, YB3-WT for tropical weather in outside and YB3-WF1 for intermediate erosion-proof weather environment in outside.

技术数据 (380V/50Hz)

型号	功率 (kW)	电流 (A)	转速 (r/min)	效率 (%)	功率因数	额定转矩	堵转转矩	最大转矩	堵转电流	噪音	重量 (kg)
							额定转矩	额定转矩	额定电流		
YB3-80M1-2	0.75	1.8	2865	77.5	0.83	2.4	2.3	2.3	6.8	67	
YB3-80M2-2	1.1	2.4	2865	82.8	0.83	3.5	2.3	2.3	7.3	67	
YB3-90S-2	1.5	3.2	2890	84.1	0.84	4.8	2.3	2.3	7.6	72	
YB3-90L-2	2.2	4.6	2890	85.6	0.85	7.0	2.3	2.3	7.8	72	
YB3-100L-2	3	6	2880	86.7	0.87	9.6	2.3	2.3	8.1	76	
YB3-112M-2	4	7.9	2910	87.6	0.88	13	2.3	2.3	8.3	77	
YB3-132S1-2	5.5	10.7	2900	88.6	0.88	18	2.2	2.3	8	80	

YB3系列隔爆型三相异步电动机
YB3 Series Frame-proof Three-phase Asynchronous Motors



技术数据 (380V/50Hz)

型号	功率 (kW)	电流 (A)	转速 (r/min)	效率 (%)	功率因数	额定转矩	堵转转矩 额定转矩	最大转矩 额定转矩	堵转电流 额定电流	噪音	重量 (kg)
YB3-132S2-2	7.5	14.3	2900	89.5	0.89	24	2.2	2.3	7.8	80	
YB3-160M1-2	11	20.8	2940	90.5	0.89	35	2.2	2.3	7.9	86	
YB3-160M2-2	15	28	2940	91.3	0.89	48	2.2	2.3	8	86	
YB3-160L-2	18.5	34.4	2940	91.8	0.89	59	2.2	2.3	8.1	86	
YB3-180M-2	22	40.7	2955	92.2	0.89	70	2.2	2.3	8.2	88	
YB3-200L1-2	30	55.1	2960	92.9	0.89	96	2.2	2.3	7.5	90	
YB3-200L2-2	37	67.7	2960	93.3	0.89	118	2.2	2.3	7.5	90	
YB3-225M-2	45	82	2970	93.7	0.89	143	2.2	2.3	7.6	92	
YB3-250M-2	55	99.9	2970	94.0	0.89	175	2.2	2.3	7.6	93	
YB3-280S-2	75	135	2970	94.6	0.89	239	2	2.3	6.9	94	
YB3-280M-2	90	162	2970	95.0	0.89	287	2	2.3	7	94	
YB3-315S-2	110	195	2980	95.0	0.90	350	2	2.2	7.1	96	
YB3-315M-2	132	234	2980	95.4	0.90	420	2	2.2	7.1	96	
YB3-315L1-2	160	280	2980	95.4	0.91	509	2	2.2	7.1	98	
YB3-315L2-2	200	350	2980	95.4	0.91	637	2	2.2	7.1	98	
YB3-355S1-2	185	324	2980	95.4	0.91	589	2	2.2	7.1	98	
YB3-355S2-2	200	350	2980	95.4	0.91	637	2	2.2	7.1	98	
YB3-355M1-2	220	385	2980	95.4	0.91	700	2	2.2	7.1	100	
YB3-355M2-2	250	436	2980	95.8	0.91	796	2	2.2	7.1	100	
YB3-355L1-2	280	488	2980	95.8	0.91	891	2	2.2	7.1	100	
YB3-355L2-2	315	549	2980	95.8	0.91	1003	2	2.2	7.1	100	
YB3-80M1-4	0.55	1.4	1430	80.7	0.75	3.5	2.3	2.3	6.3	58	
YB3-80M2-4	0.75	1.8	1430	82.3	0.75	4.8	2.3	2.3	6.5	58	
YB3-90S-4	1.1	2.7	1430	83.8	0.75	7.0	2.3	2.3	6.6	61	
YB3-90L-4	1.5	3.6	1430	85.0	0.75	9.6	2.3	2.3	6.9	61	
YB3-100L1-4	2.2	4.8	1440	86.4	0.81	14	2.3	2.3	7.5	64	
YB3-100L2-4	3	6.4	1440	87.4	0.82	19	2.3	2.3	7.6	64	
YB3-112M-4	4	8.4	1445	88.3	0.82	25	2.3	2.3	7.7	65	
YB3-132S-4	5.5	11.4	1455	89.2	0.82	35	2	2.3	7.5	71	
YB3-132M-4	7.5	15.2	1455	90.1	0.83	48	2	2.3	7.4	71	
YB3-160M-4	11	21.6	1465	91.0	0.85	70	2.2	2.3	7.5	75	
YB3-160L-4	15	28.9	1465	91.8	0.86	96	2.2	2.3	7.5	75	
YB3-180M-4	18.5	35.4	1475	92.2	0.86	118	2.2	2.3	7.7	76	
YB3-180L-4	22	42	1475	92.6	0.86	140	2.2	2.3	7.8	76	
YB3-200L-4	30	56.9	1475	93.2	0.86	191	2.2	2.3	7.2	79	
YB3-225S-4	37	69.8	1480	93.6	0.86	236	2.2	2.3	7.3	81	
YB3-225M-4	45	84.7	1480	93.9	0.86	287	2.2	2.3	7.4	81	
YB3-250M-4	55	103	1480	94.2	0.86	350	2.2	2.3	7.4	83	
YB3-280S-4	75	137	1485	94.7	0.88	478	2.2	2.3	6.7	86	
YB3-280M-4	90	164	1485	95.0	0.88	573	2.2	2.3	6.9	86	
YB3-315S-4	110	199	1490	95.4	0.88	700	2.2	2.2	6.9	93	



YB3 系列隔爆型三相异步电动机
YB3 Frame-proof Three-phase Asynchronous Motors

技术数据 (380V/50Hz)

型号	功率 (kW)	电流(A)	转速 (r/min)	效率 (%)	功率因数	额定转矩	堵转转矩 额定转矩	最大转矩 额定转矩	堵转电流 额定电流	噪音	重量 (kg)
YB3-315M-4	132	239	1490	95.4	0.88	840	2.2	2.2	6.9	93	
YB3-315L1-4	160	286	1490	95.4	0.89	1019	2.2	2.2	6.9	94	
YB3-315L2-4	200	358	1490	95.4	0.89	1273	2.2	2.2	6.9	94	
YB3-355S1-4	185	331	1490	95.4	0.89	1178	2.2	2.2	6.9	94	
YB3-355S2-4	200	358	1490	95.4	0.89	1273	2.2	2.2	6.9	94	
YB3-355M1-4	220	389	1490	95.4	0.90	1401	2.2	2.2	6.9	95	
YB3-355M2-4	250	441	1490	95.8	0.90	1592	2.2	2.2	6.9	95	
YB3-355L1-4	280	493	1490	95.8	0.90	1783	2.2	2.2	6.9	95	
YB3-355L2-4	315	555	1490	95.8	0.90	2006	2.2	2.2	6.9	95	
YB3-80M1-6	0.37	1.3	910	63.0	0.70	3.5	1.9	2.1	4	54	
YB3-80M2-6	0.55	1.5	910	75.4	0.72	5.3	1.9	2.1	4	54	
YB3-90S-6	0.75	2	940	77.7	0.72	7.2	2.1	2.1	5.8	57	
YB3-90L-6	1.1	2.9	940	79.9	0.73	11	2.1	2.1	5.9	57	
YB3-100L-6	1.5	3.8	955	81.5	0.74	14	2.1	2.1	6	61	
YB3-112M-6	2.2	5.4	955	83.4	0.74	21	2.1	2.1	6	65	
YB3-132S-6	3	7.3	970	84.9	0.74	29	2	2.1	6.2	69	
YB3-132M1-6	4	9.5	970	86.1	0.74	38	2	2.1	6.8	69	
YB3-132M2-6	5.5	12.7	970	87.4	0.75	53	2	2.1	7.1	69	
YB3-160M-6	7.5	16.4	975	89.0	0.78	72	2.1	2.1	6.7	73	
YB3-160L-6	11	23.5	975	90.0	0.79	105	2.1	2.1	6.9	73	
YB3-180L-6	15	30.9	980	91.0	0.81	143	2	2.1	7.2	73	
YB3-200L1-6	18.5	37.9	980	91.5	0.81	177	2.1	2.1	7.2	76	
YB3-200L2-6	22	44.3	980	92.0	0.82	210	2.1	2.1	7.3	76	
YB3-225M-6	30	60.8	985	92.5	0.81	287	2	2.1	7.1	76	
YB3-250M-6	37	72	985	93.0	0.84	353	2.1	2.1	7.1	78	
YB3-280S-6	45	85	990	93.5	0.86	430	2.1	2	7.2	80	
YB3-280M-6	55	104	990	93.8	0.86	525	2.1	2	7.2	80	
YB3-315S-6	75	142	990	94.2	0.85	716	2	2	6.7	85	
YB3-315M-6	90	172	990	94.5	0.84	860	2	2	6.7	85	
YB3-315L1-6	110	207	990	95.0	0.85	1051	2	2	6.7	85	
YB3-315L2-6	132	245	990	95.0	0.86	1261	2	2	6.7	85	
YB3-355S-6	160	294	990	95.0	0.87	1528	2	2	6.7	92	
YB3-355M1-6	185	340	990	95.0	0.87	1767	2	2	6.7	92	
YB3-355M2-6	200	368	990	95.0	0.87	1910	2	2	6.7	92	
YB3-355L1-6	220	404	990	95.0	0.87	2101	2	2	6.7	92	
YB3-355L2-6	250	460	990	95.0	0.87	2388	2	2	6.7	92	
YB3-80M1-8	0.18	0.9	670	52.0	0.61	2.3	1.8	1.9	3.3	52	
YB3-80M2-8	0.25	1.1	670	55.0	0.61	3.2	1.8	1.9	3.3	52	
YB3-90S-8	0.37	1.4	690	63.0	0.62	4.7	1.8	2	4	56	
YB3-90L-8	0.55	1.8	690	74.0	0.63	7.0	1.8	2	4	56	
YB3-100L1-8	0.75	2.3	695	74.0	0.68	9.6	1.8	2	4	59	

YB3系列隔爆型三相异步电动机
YB3 Series Frame-proof Three-phase Asynchronous Motors



技术数据 (380V/50Hz)

型号	功率 (kW)	电流(A)	转速 (r/min)	效率 (%)	功率 因数	额定 转矩	堵转转矩	最大转矩	堵转电流	噪音	重量 (kg)
							额定转矩	额定转矩	额定电流		
YB3-100L2-8	1.1	3.1	695	77.0	0.69	14	1.8	2	4	59	
YB3-112M-8	1.5	4	695	82.5	0.69	19	1.8	2	4	61	
YB3-132S-8	2.2	5.5	710	84.0	0.73	28	1.8	2.2	5.5	64	
YB3-132M-8	3	7.3	710	85.5	0.73	38	1.8	2.2	5.5	64	
YB3-160M1-8	4	9.7	715	85.5	0.73	51	1.9	2.2	6	68	
YB3-160M2-8	5.5	13	715	85.5	0.75	70	1.9	2.2	6	68	
YB3-160L-8	7.5	16.9	715	88.5	0.76	96	1.9	2.2	6	68	
YB3-180L-8	11	24.8	725	88.5	0.76	140	1.9	2.2	6	70	
YB3-200L-8	15	33.5	730	89.5	0.76	191	2	2.2	6.5	73	
YB3-225S-8	18.5	40.3	730	89.5	0.78	236	2	2.2	6.5	73	
YB3-225M-8	22	47.1	730	91.0	0.78	280	2	2.2	6.5	73	
YB3-250M-8	30	63.4	735	91.0	0.79	382	1.9	2	6.5	75	
YB3-280S-8	37	77.6	740	91.7	0.79	471	1.8	2	6	76	
YB3-280M-8	45	94.4	740	91.7	0.79	573	1.8	2	6	76	
YB3-315S-8	55	111	740	93.0	0.81	700	1.8	2	6.5	82	
YB3-315M-8	75	151	740	93.0	0.81	955	1.8	2	6.5	82	
YB3-315L1-8	90	180	740	93.6	0.81	1146	1.8	2	6.5	82	
YB3-315L2-8	110	218	740	93.6	0.82	1401	1.8	2	6.5	82	
YB3-355S-8	132	268	740	91.1	0.82	1681	1.8	2	6.5	90	
YB3-355M-8	160	325	740	91.1	0.82	2037	1.8	2	6.5	90	
YB3-355L1-8	185	376	740	91.1	0.82	2356	1.8	2	6.5	90	
YB3-355L2-8	200	387	740	94.5	0.83	2547	1.8	2	6.5	90	
YB3-315S-10	45	100	590	91.5	0.75	716	1.5	2	6	82	
YB3-315M-10	55	121	590	92.0	0.75	875	1.5	2	6	82	
YB3-315L1-10	75	162	590	92.5	0.76	1194	1.5	2	6	82	
YB3-315L2-10	90	191	590	93.0	0.77	1433	1.5	2	6	82	
YB3-355S-10	90	191	590	93.0	0.77	1433	1.5	2	6	90	
YB3-355M1-10	110	230	590	93.2	0.78	1751	1.3	2	5.5	90	
YB3-355M2-10	132	275	590	93.5	0.78	2101	1.3	2	5.5	90	
YB3-355L1-10	160	333	590	93.5	0.78	2547	1.3	2	5.5	90	
YB3-355L2-10	185	385	590	93.5	0.78	2945	1.3	2	5.5	90	



YB3 系列隔爆型三相异步电动机
YB3 Frame-proof Three-phase Asynchronous Motors

机座号与转速及功率的对应关系

Correspondences between frame No. and rotational speed, power

机座号 Frame No	同步转速 Synchronous speed r/min				
	3000	1500	1000	750	600
功率					
63M1	0.18	0.12	—	—	—
63M2	0.25	0.18			
71M1	0.37	0.25	0.18		
71M2	0.55	0.37	0.25		
80M1	0.75	0.55	0.37	0.18	
80M2	1.1	0.75	0.55	0.25	
90S	1.5	1.1	0.75	0.37	
90L	2.2	1.5	1.1	0.55	
100L1	3	2.2	1.5	0.75	
100L2		3		1.1	
112M	4	4	2.2	1.5	
132S1	5.5	5.5	3	2.2	
132S2	7.5				
132M1	—	7.5	4	3	
132M2			5.5		
160M1	11	11	7.5	4	
160M2	15			5.5	
160L	18.5	15	11	7.5	
180M	22	18.5	—	—	
180L	—	22	15	11	

机座号与转速及功率的对应关系

Correspondences between frame No. and rotational speed, power

机座号 Frame No	同步转速 Synchronous speed r/min				
	3000	1500	1000	750	600
	功率				
200L1	30	30	18.5	15	---
200L2	37		22		
225S	---	37	---	18.5	
225M	45	45	30	22	
250M	55	55	37	30	
280S	75	75	45	37	
280M	90	90	55	45	
315S	110	110	75	55	45
315M	132	132	90	75	55
315L1	160	160	110	90	75
315L2	200	200	132	110	90
355S1	(185)	(185)	160	132	(90)
355S2	(200)	(200)			
355M1	(220)	(220)	(185)	160	110
355M2	250	250	200		132
355L1	(280)	(280)	(220)	(185)	160
355L2	315	315	250	200	(185)

注 1：带括号的为不优先推荐规格。

注 2：S、M、L 后面的数字 1、2 代表同一机座号和转速下不同的功率。



YB3系列隔爆型三相异步电动机
YB3 Frame-proof Three-phase Asynchronous Motors

外形及安装尺寸

Contour and installation dimensions

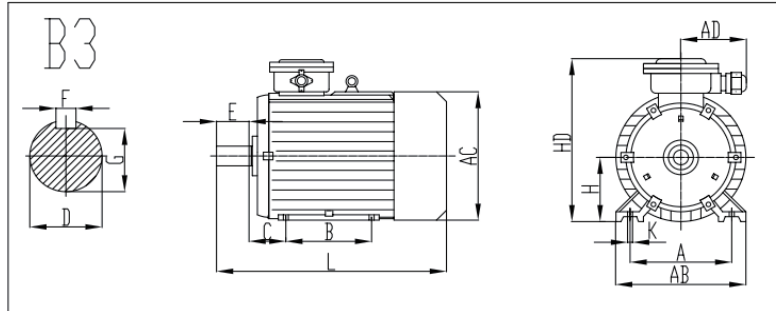

机座号	极数	B3 外形尺寸																							
		A	B	C	D	E	F	G	H	K	AB	AC	AD	HD	L										
63M	2.4	100	80	40	11	23	4	8.5	63	7	130	150	165	230	270										
71M	2.4.6	112	90	45	14	30	5	11	71		140	155		250	300										
80M	2.4.6. 8	125	10	50	19	40	6	15.5	80	10	165	165	180	320	330										
90S		140	0	56	24	50	8	20	90		12	180		180	200	350	360								
90L			12							385															
100L		160	14	63	28	60	10	24	100	12	200	205	200	400	440										
112M		190	0	70	89	38		80	10		33	132		245	230	200	420	460							
132S		216	17	89			38			80			10	33	132		280	270	200	450	510				
132M		254	21	108	42	110	12	37	160	14.5	330	325	220	520	670										
160M		254	25	108	42											12	37	160	14.5	330	325	220	520	670	
160L		279	24	121	48	110	14	42.5	180	18.5	355	360	220	550	730										
180M		279	27	121	48											14	42.5	180	18.5	355	360	220	550	730	
180L	318	30	133	55	140	16	49	200	24	390	400	250	645	805											
200L	318	30	133	55											16	49	200	24	390	400	250	645	805		
225S	4.8	356	28	149	60	140	18	53	225	18.5	435	450	250	690	865										
225M	2		31		55	110	16	49								225	18.5	435	450	250	690	865			
225M	4.6.8		1		60	18	53	225								18.5	435	450	250	690	865				
250M	2	406	34	168	65	140	18	58	250	24	490	500	300	730	945										
250M	4.6.8		9													65	18	58	250	24	490	500	300	730	945
280S	2	457	36	190	75	140	20	67.5	280	24	545	560	300	810	1010										
280S	4.6.8		8													75	20	67.5	280	24	545	560	300	810	1010
280M	2		41													65	18	58	280	24	545	560	300	810	1060
280M	4.6.8	9	75	20	67.5	280	24	545	560	300	810	1060													
315S	2	508	40	216	65	140	18	58	315	28	640	630	400	1020	1320										
315S	4.6.8.		6		80											170	22	71	315	28	640	630	400	1020	1320
315M	2		45		65											140	18	58	315	28	640	630	400	1020	1350
315M	4.6.8.		7		80											170	22	71	315	28	640	630	400	1020	1380
315L	2	508	50	216	65	140	18	58	315	28	640	630	400	1020	1490										
315L	4.6.8.		8		80											170	22	71	315	28	640	630	400	1020	1520
355S	2		50		75											140	20	67.5	355	28	740	750	500	1080	1570
355S	4.6.8.		0		95											170	25	86							
355M	2	610	56	254	75	140	20	67.5	355	28	740	750	500	1080	1650										
355M	4.6.8.		0		95											170	25	86	355	28	740	750	500	1080	1650
355L	2		63		75											140	20	67.5	355	28	740	750	500	1080	1750
355L	4.6.8.		0		95											170	25	86							

YB3系列隔爆型三相异步电动机
YB3 Series Frame-proof Three-phase Asynchronous Motors



外形及安装尺寸

Contour and installation dimensions

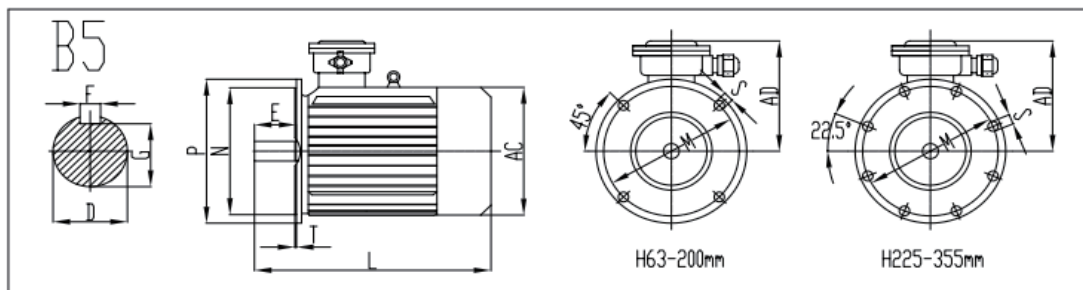

机座号	凸缘号	极数	B5 外形尺寸																					
			D	E	F	G	M	N	P	S	T	AC	AD	L										
63M	FF115	2.4	11	23	4	8.5	115	95	140	φ10	3	130	170	270										
71M	FF130	2.4.6	14	30	5	11	130	110	160			145		300										
80M	FF165	2.4.6.	19	40	6	15.5	165	130	200	φ12	3.5	165	240	330										
90S			24	50	8	20						180		260	360									
90L			24	50		20						180		260	385									
100L	FF215	2.4.6.	28	60	8	24	215	180	250	φ14.5	4	205	300	440										
112M	FF265		38	80		10	33	265	230			300		230	310	460								
132S	FF265		38	80		10	33	265	230			300		270	320	510								
132M		38	80	10	33	265	230	300	270	320	550													
160M	FF300	8	42	110	12	37	300	250	350	φ18.5	5	325	360	670										
160L			42		12	37						325		360	710									
180M			48		14	42.5						360		370	730									
180L			48		14	42.5						360		370	750									
200L	FF350	4.8	55	140	16	49	350	300	400	φ18.5	5	400	445	805										
225S	2		55		16	49	400	350	450			450		465	865									
225M	4.6.8		55		16	49	400	350	450			450		465	890									
250M	FF500	2	140	18	53	500	450	550	φ18.5	5	5	500	500	945										
280S		4.6.8										65		20	67.5	500	450	550	φ18.5	5	5	560	550	1010
		2										65												
280M		4.6.8										65		18	58	500	450	550	φ18.5	5	5	560	550	1060
		2										65		18	58									
315S		FF600										2		65	170	22	71	600	550	660	φ24	6	630	705
315M	4.6.8.		80	170	22	71																		
	2		65	140	18	58																		
315L	4.6.8.		80	170	22	71																		
355S	FF740	2	75	140	20	67.5	740	680	800	φ24	6	750	725	---										
355M		4.6.8.	95	170	25	86																		
		2	75	140	20	67.5																		
355L		4.6.8.	95	170	25	86																		
		2	75	140	20	67.5																		



YB3 系列隔爆型三相异步电动机
YB3 Frame-proof Three-phase Asynchronous Motors

外形及安装尺寸

Contour and installation dimensions

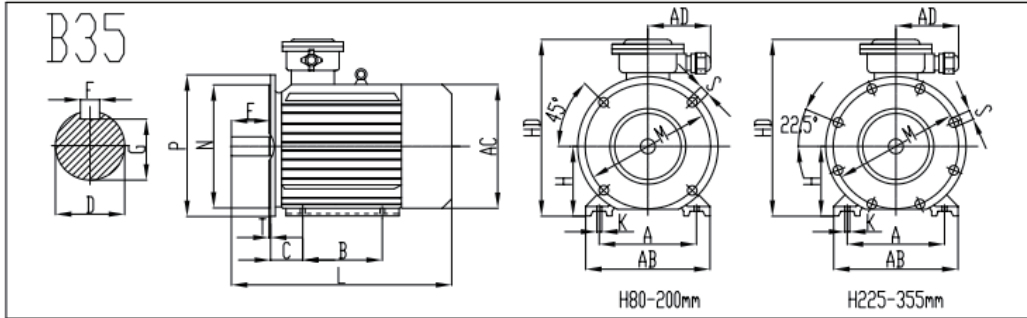

机座号	凸缘号	极数	B35 外形尺寸																									
			A	B	C	D	E	F	G	H	K	M	N	P	S	T	AB	AC	AD	HD	L							
80M	FF165	2.4.6.8	125	100	50	19	40	6	15.5	80	10	165	130	200	φ12	3.5	165	165	180	320	330							
90S			140	56	24	50	8	20	90	12							215	180			250	φ14.5	4	180	180	200	400	360
90L			125																					385				
100L	FF215		160	63	28	60	24	100	12	265	230	300	φ18.5	5	200	205	220	420	440									
112M			190	70	110	14	42.5	180							245	230			460									
132S	FF265		216	89	38	80	10	33	132	15	300	250	350	φ18.5	5	280	270	250	645	510								
132M			178	550																								
160M	FF300		254	210	108	42	12	37	160	19	400	350	450	φ18.5	5	330	325	220	520	670								
160L			254	110	14	42.5	180	350	350							710												
180M			279	241	121	48	14	42.5	180							350	350			730								
180L		279	750																									
200L	FF350	318	305	133	55	16	49	200	24	500	450	550	φ18.5	5	390	400	300	810	805									
225S	FF400	4.8	286	149	60	140	18	53							225	19			400	350	450	φ18.5	5	435	450	690	865	
90S		2	356		55	110	16	49																			865	
225M		4.6.8	311	60	53	890																						
250M	FF500	2	406	349	168	140	18	53	250	24	500	450	550	φ18.5	5	490	500	300	730	945								
280S		4.6.8	457	368	190		65	58								280	545			560	810	1010						
280M		2				419	65	18															58					
280M		4.6.8	419	65	20	67.5	1060																					
315S	FF600	2	406	216	65	140	20	67.5	315	28	600	550	660	φ24	6	640	630	400	1020	1320								
315M		4.6.8.10			80	170	22	71												1350								
315M		2	508	457	65	140	18	58												1490								
315L		4.6.8.10	508	65	140	18	58	1520																				
355S	FF740	2	500	254	75	140	20	67.5	355	740	680	800	φ24	6	740	750	500	1080	1570									
355M		4.6.8.10			95	170	25	86											1650									
355M		2	610	560	75	140	20	67.5											1650									
355L		4.6.8.10	610	95	170	25	86	1750																				
355L	2	630	75	140	20	67.5	1750																					
355L	4.6.8.10	630	95	170	25	86	1750																					

外形及安装尺寸

Contour and installation dimensions

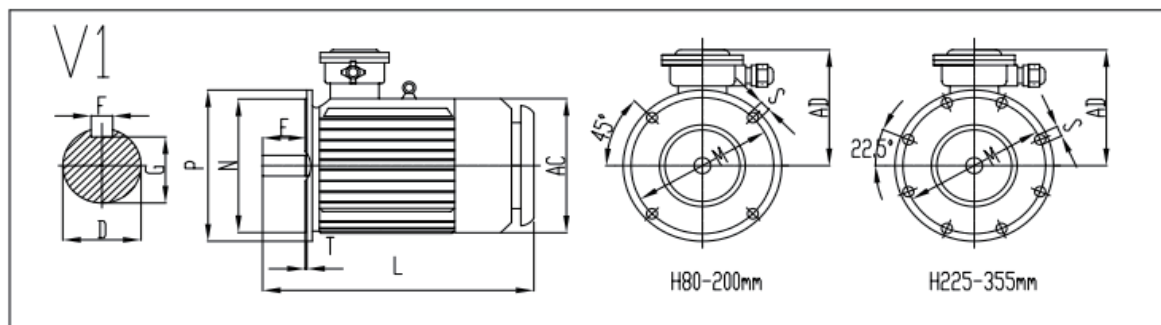

机座号	凸缘号	极数	B5 外形尺寸												
			D	E	F	G	M	N	P	S	T	AC	AD	L	
63M	FF115	2.4	11	23	4	8.5	115	95	140	φ 10	3	130	170	310	
71M	FF130	2.4.6	14	30	5	11	130	110	160			145		340	
80M	FF165	2.4.6.8	19	40	6	15.5	165	130	200	φ 12	3.5	165	240	375	
90S			8	20	180	260						405			
90L							430								
100L			FF215	28	60	24	215	180	250			φ 14.5	4	205	300
112M	230	310		520											
132S	FF265	2.4.6.8	38	80	10	33	265	230	300	φ 14.5	4	270	320	590	
132M			630												
160M	FF300	2.4.6.8	42	110	12	37	300	250	350	φ 18.5	5	325	360	730	
160L			14		42.5	360						370		770	
180M							48	800							
180L			820												
200L	FF350	55	16	49	350	300	400	φ 18.5	5	400	445	875			
225S	FF400	4.8	60	140	18	53	400			350	450	φ 18.5	5	450	465
225M		2	55	110	16	49		930							
225M		4.6.8	60	53	960										
250M	FF500	2.4.6.8	2	140	18	58	500	450	550	φ 18.5	5	500	500	1035	
280S			4.6.8									65		20	67.5
280M			2		65	18						58	1150		
280M			4.6.8		75	20						67.5			
315S	FF600	2.4.6.8.10	2	65	140	18	58	600	550	660	φ 24	6	630	705	1340
315M			4.6.8.10	80	170	22	71								1420
315L			2	65	140	18	58								1510
315L			4.6.8.10	80	170	22	71								1540
355S	FF740	2.4.6.8.10	2	75	140	20	67.5	740	680	800	φ 24	6	750	725	1600
355M			4.6.8.10	95	170	25	86								
355M			2	75	140	20	67.5								1780
355L			4.6.8.10	95	170	25	86								